



Gourmet 10T Master Pro

Electrical Supply

CODE: 926007630

Seats	80/160
Trays	10T GN 1/1
Outside dimension	715 L x 800 P x 1000 H mm
Tray distance	65 mm
Power	11 kW
Weight	90 Kg
Max temperature	270° C
Power supply	400 V ~ 3PH + N + PE 400 V ~ 2PH + N + PE 230 V ~ 3PH + PE 230 V ~ 1PH + N + PE 50-60 Hz

Equipment

Display touch screen 7 inches LCD
Double low emissive glass
USB connection
Usable also with GN2/3 and GN1/2 trays
Five fan speeds and semi-static cooking
Program blocking with password
CE Certificate

Automatic control of the cooking level and load
Customized programs mode
Automatic preheating
Delayed cooking programming
Automatic detection and errors report
Openable inner glass for easy cleaning

Led illumination
High-performance thermal insulation
Blue LED for chamber cleaning check
Core probe MultiBakePOINT
Nine cooking modes
Rounded baking chamber
Automatic control of dry/steam balance inside the chamber
Multi-timer function for multiple and mixed cooking
Manual mode
Cooling program
Cooking chamber automatic cooling
Safety rinse
Fan inversion, speed control and motor brake

BakeAIR multi-fan system
BakeCLEAN automatic washing system
Water collection tray
Set-up for BakeHIN vacuum core probe
Automatic chimney opening BakeDRY
Modularity
Steam control in percentage BakeSTEAM
Storage, viewing* and exportation of cooking data (haccp)
Preset programs mode
Delayed start programming
Pre-loaded and online cookbook
Overlap option
Adaptive steam pressure and chamber saturation control

Options

BakeHIN vacuum core probe

Fat collection BakeFAT

Left door opening

Gourmet 10T Master Pro

Electrical Supply

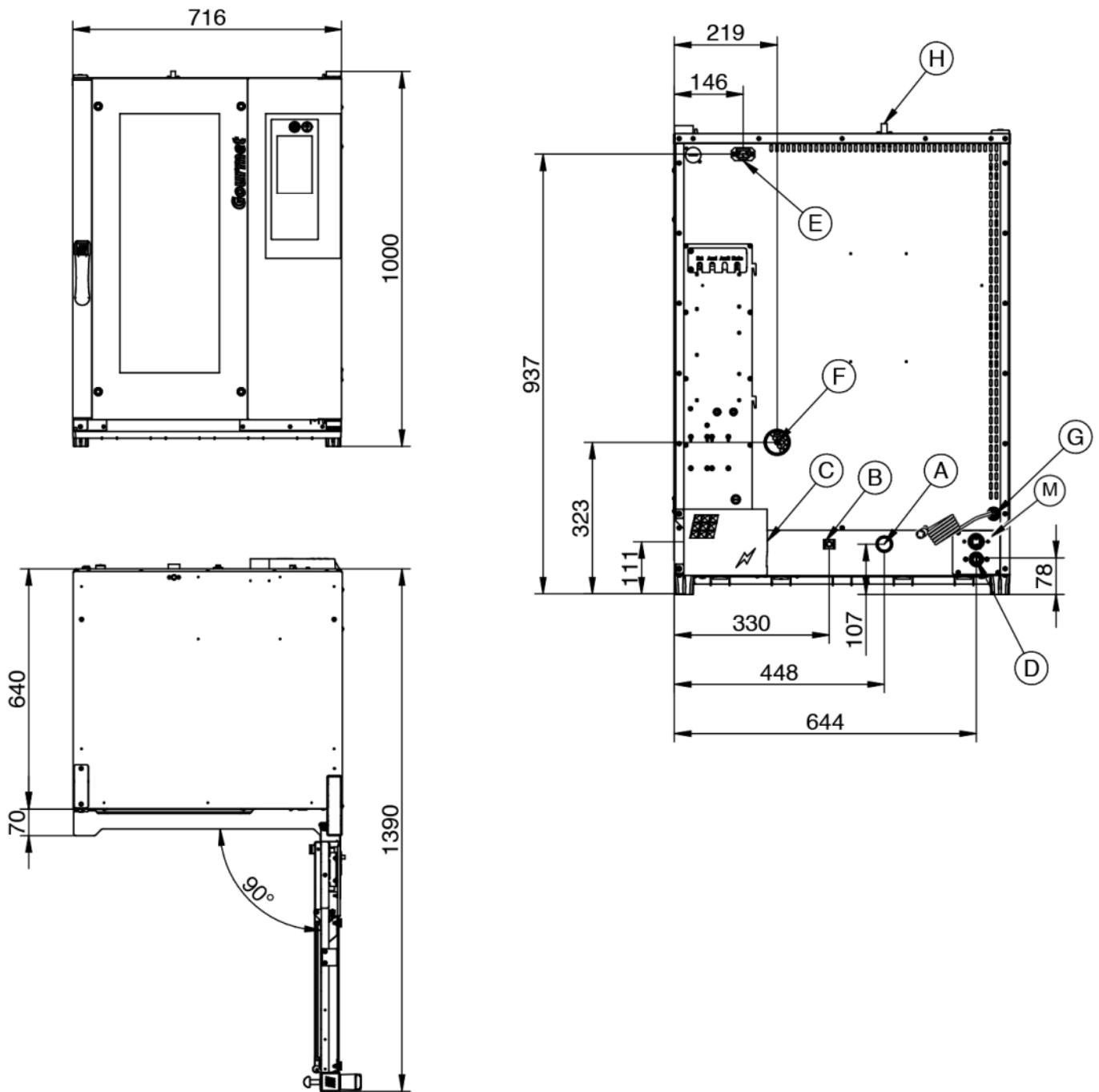

Legend

- A - Drain liquid Ø 30mm
- B - Equipotential terminal comb
- C - Electric supply
- D - Water inlet 3/4" steam
- E - Extracting hood supply
- F - Steam exhaust Ø 50mm

- G - Inlet for Clean and Care
- H - Depressurizer Ø 12mm
- M - Water inlet 3/4" washing

Gourmet 10T Master Pro

Electrical Supply

Supply and Connections

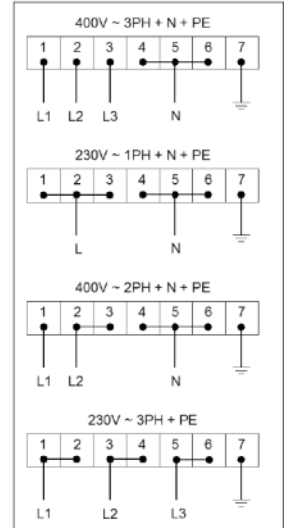

Packaging

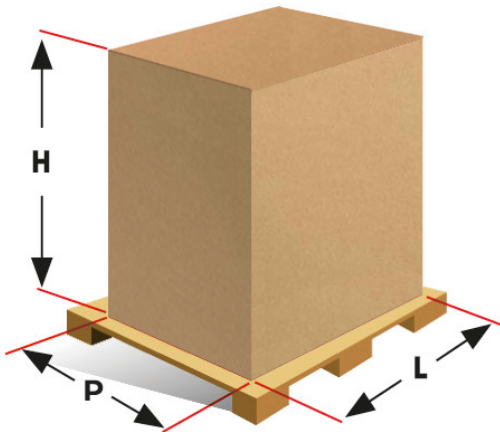

Packing size:	790 L x 870 P x 1140 H mm
Net weight:	90 Kg
Gross weight:	104 Kg